

SEP 15 1945
 1945

The bearer is authorized to visit Mulhouse, from _____ to 2330 hours.

By order of Major MONSON:

Arthur G. Petrich
 ARTHUR G. PETRICH
 Captain CAC
 Adjutant

BILLETS	PACKET NO.	AVAILABLE AT BLDG NO. 14	
BLDG <u>5</u>		Beer	1 2 3 4 5 6 Sngs Shine 1
ROOM <u>2024</u>		Coca Cola	1/3 Haircut 1
		Ice Cream	1/2

- Camp Regulation and Information -

- Meal Hours: Officers - 0545-0800, 1200-1500, 1730-2000.
 Bldg. Number 4.
 Enlisted Men - 0540-0730, 1200-1500, 1730-2000.
 Bldg. Number 13.
- Sick Call: Bldg. Number 20 - 0830 daily.
- ~~Baggage check rooms in Camp are in basement of Building # 3.~~ Check baggage you will leave here during your trip to Switzerland before 2330 of processing date.
- French M.P.s may check your pass in town. They are authorized to do so.
- If for any reason you return either before or after your return date, report to processing at Post Headquarters, Bldg. 1.

- Travel light into Switzerland. The following are necessary:
 Class "A" uniform
 Raincoat
 Change of underwear
 Extra Socks
 Extra handkerchiefs
 Toilet articles
 Towel
 Cigarettes and tobacco
 Sun Glasses (Optional)
- Travel light No blankets or mess gear are needed.
- You must be in the assembly area in front of Bldg. 2, ready to leave by 0620, tomorrow morning. You will be called by billet Charge of Quarters at 0515.
- Nurses, Wacs and other personnel billeted outside camp must be at Swiss Leave railhead by 0630 tomorrow morning.

Baggage Check No. C1632

Item: 3/1 / 23

REPORT TO BLDG # 4 - At _____ HRS.

(OVER)

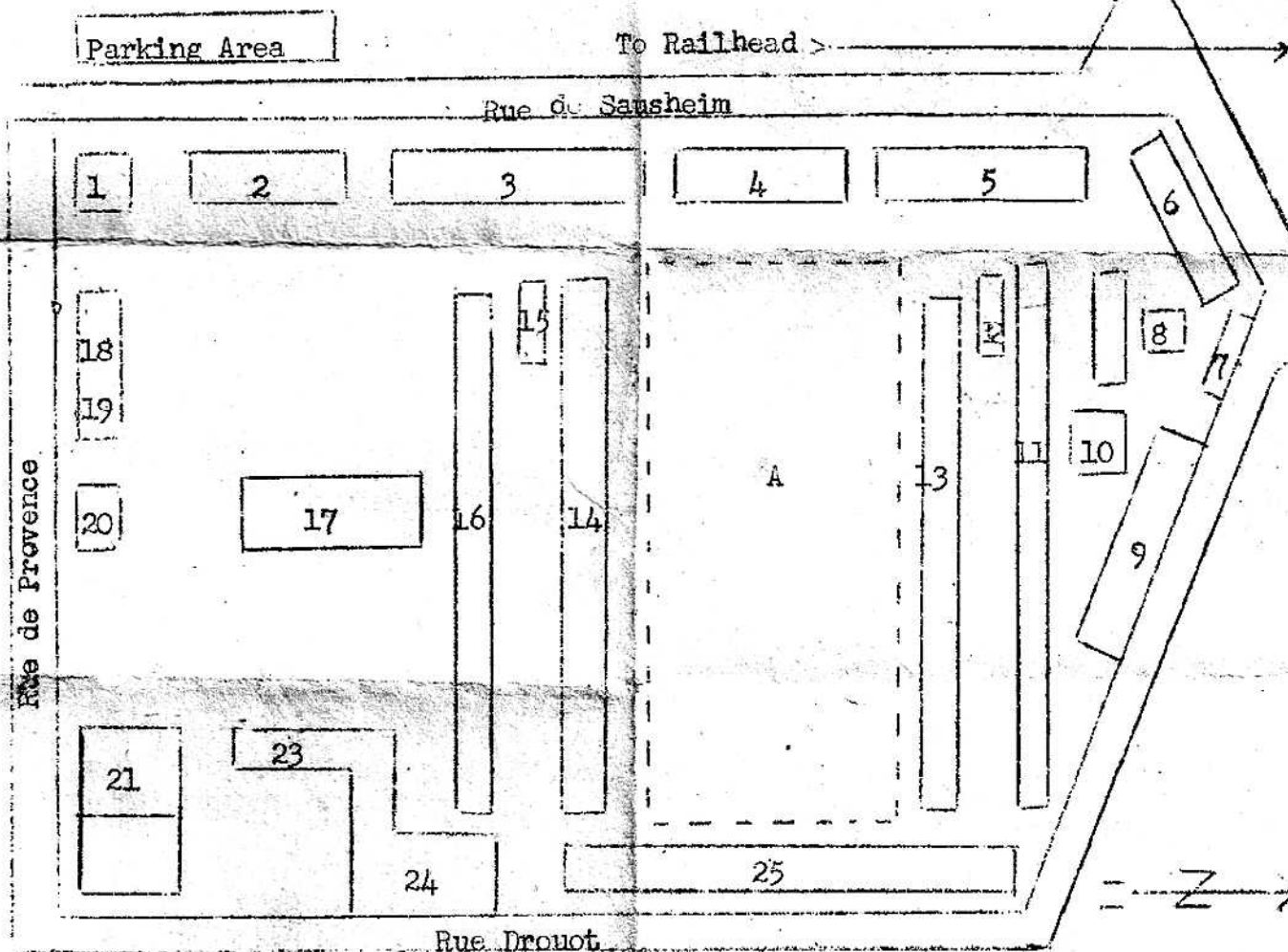

LEGEND

- | | |
|---------------------------------------|-------------------------------|
| 1. Camp Headquarters | 15. Latrine |
| 2. Transit O's Billets | 16. Storage |
| 3. E/M Billets | 17. Theater |
| 4. Processing Room - Transit O's Mess | 18. Headquarters Btry, 112 Bn |
| 5. Transit E/M Billets | 19. "A" Btry 112th Bn |
| 6. POW Enclosure | 20. Dispensary |
| 7. " " | 21. EM Staff Billets |
| 8. " " | 22. Camp Staff O's Quarters |
| 9. " " | 23. Utilitis |
| 10. Swimming Pool | 24. Motor Pool |
| 11. Polish Guard Billets | 25. Post Supply |
| 12. Latrine | A. Athletic field |
| 13. EM Mess (Transits) | B. Parking Area |
| 14. Beer Garden, PX, Red Cross | C. Railhead |